

**C.E.**  
**Sunny**  
**P.R.E.M.I.U.M.**

THE SOLAR SHOWER

ASSEMBLING INSTRUCTIONS

**This shower system is suitable for any external area and uses natural solar energy, thus is capable of providing free hot water.**

Sunny uses the energy from the sun's rays to produce hot water ecologically and without using any electricity. Just like a solar panel, the storage tank-base of the shower is connected to the water network and is exposed to the sun for about 2 hours, it heats the water therein to over 60°C/140°F. This water appropriately combined with cold water through the mixer, enables a hot water supply at approximately 30°C/86°F. Therefore, the shower system can provide 7/8 consecutive shower sessions of about two minutes each, however if there is a few minutes in between each session, then basically the system could provide an infinite number of showers during the whole day. The pressure control valve placed on the base of the unit provides total safety and comfort even to small children.

# ASSEMBLY

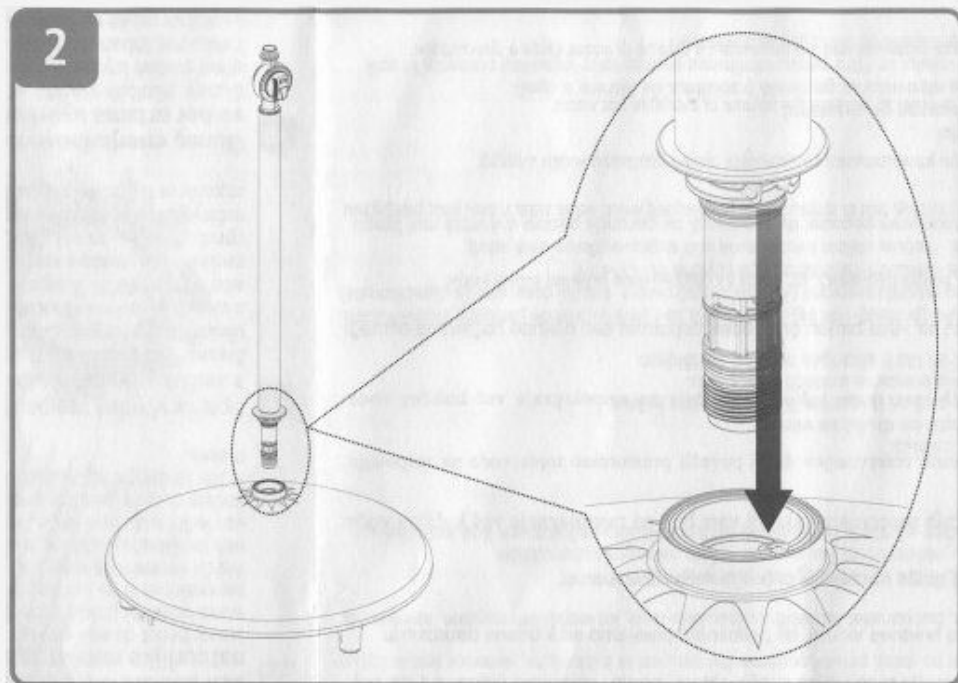
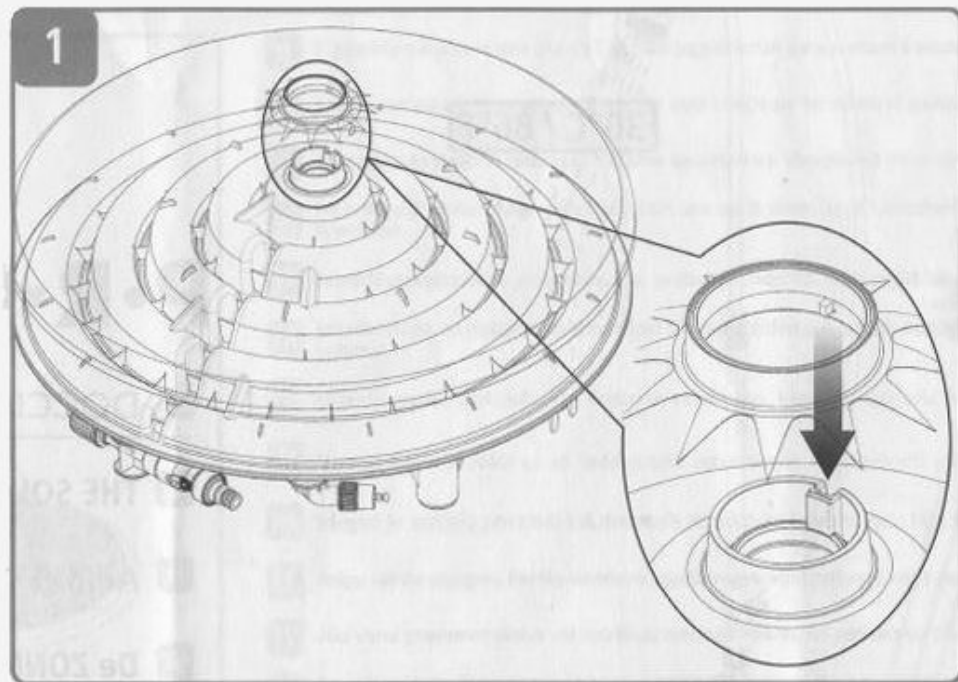
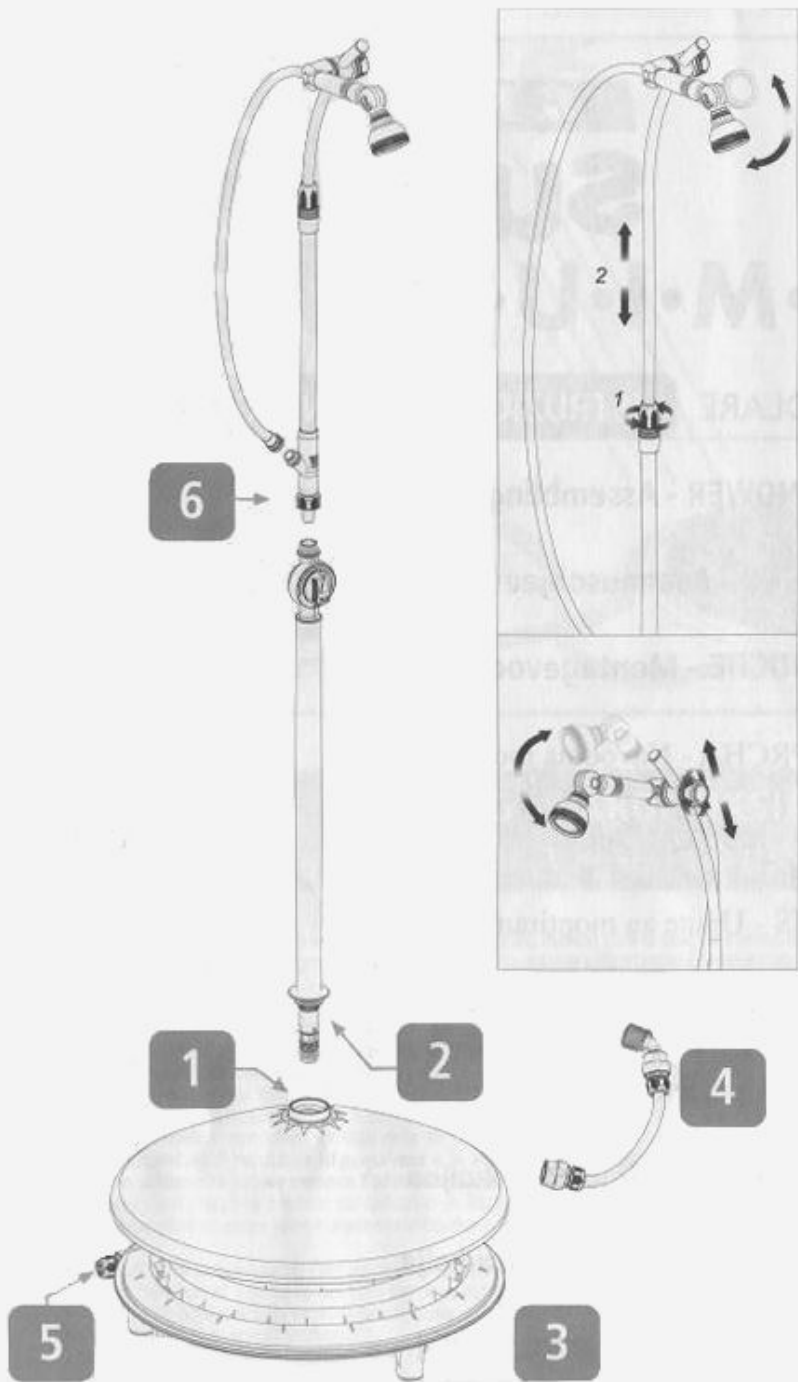

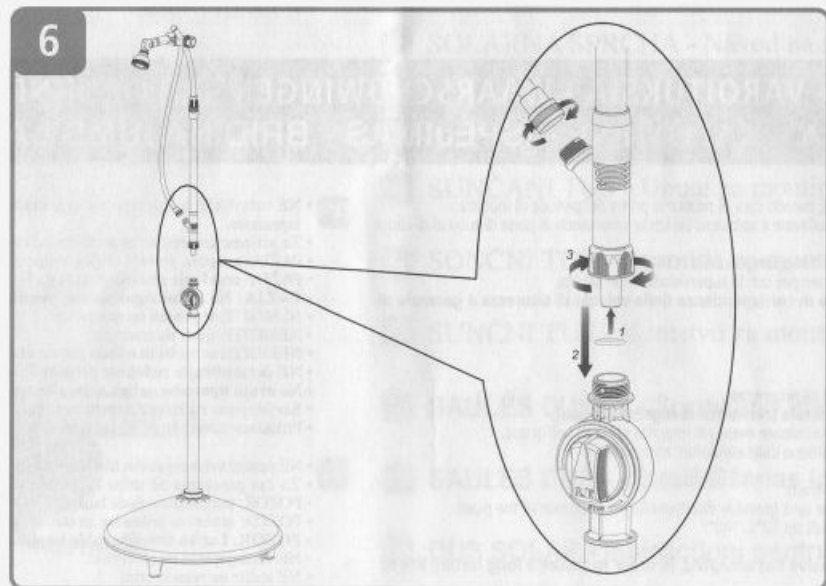
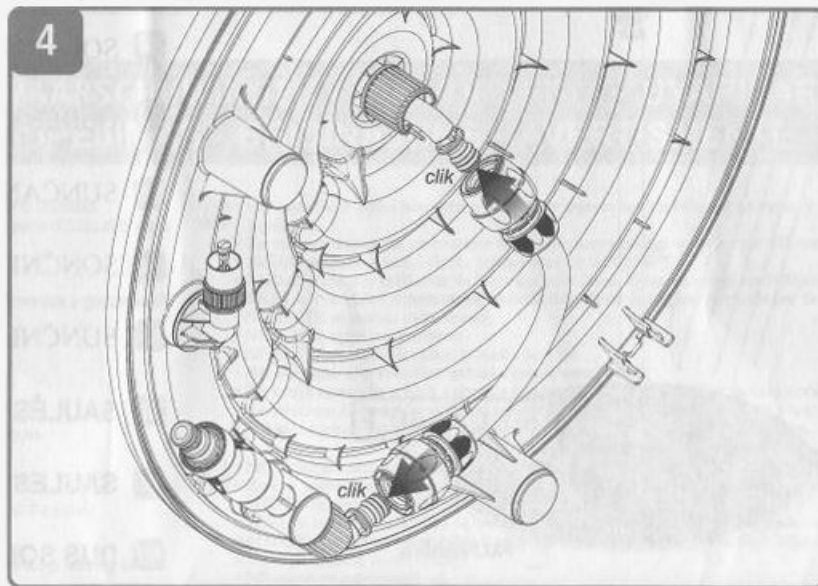
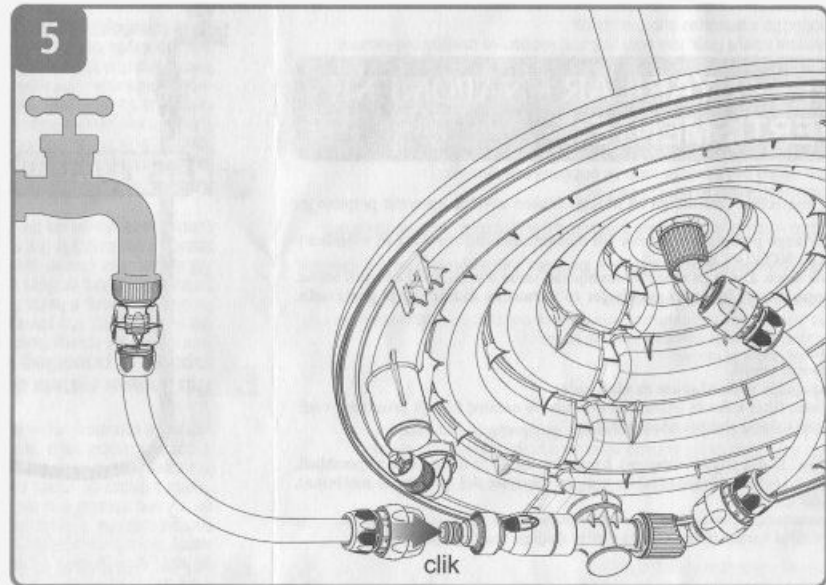
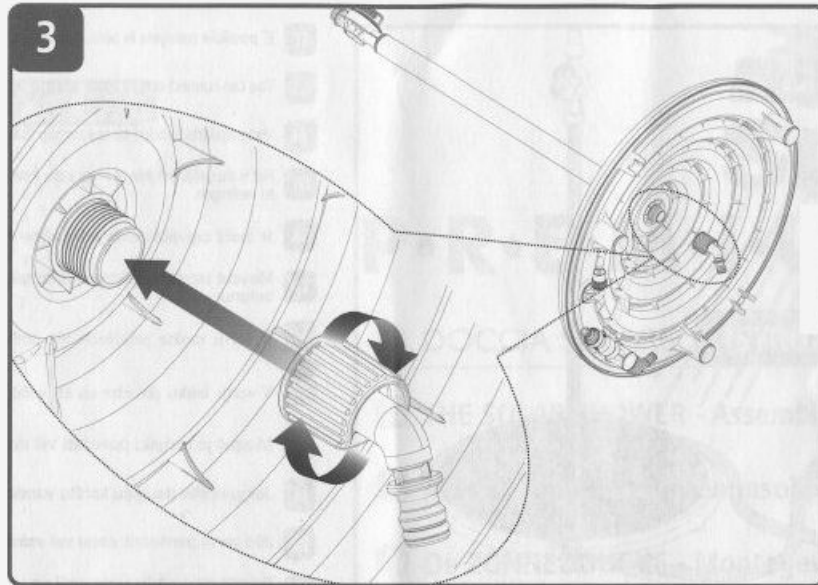

Angle the tank sideways (setting it against one of its 3 plastic feet) and screw tight the ringed union elbow to the protruding thread of the black pole until it is completely fastened (the elbow union is free to turn).

## UTILIZATION

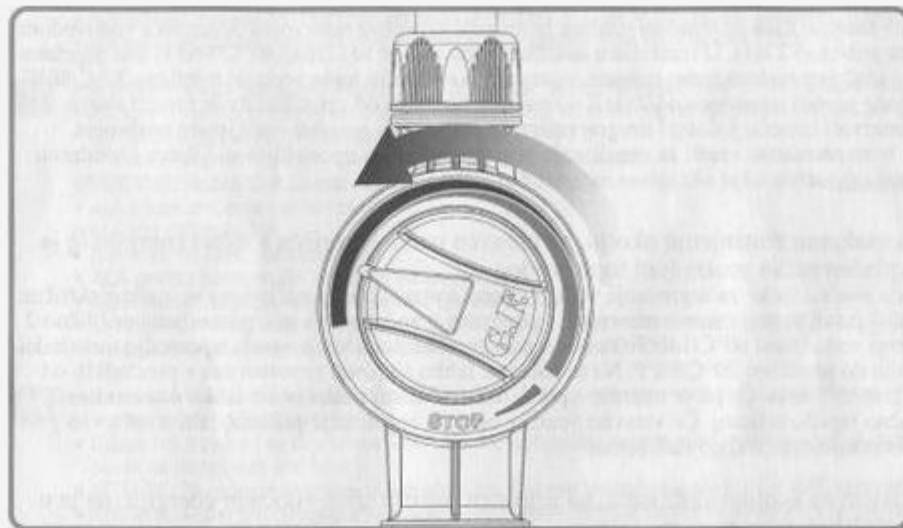

Note: when filling the tank, switch the mixer knob to hot water until the air is completely expelled (you will notice a uniform water flow). Then switch the knob to stop. Wait for the water to warm-up.

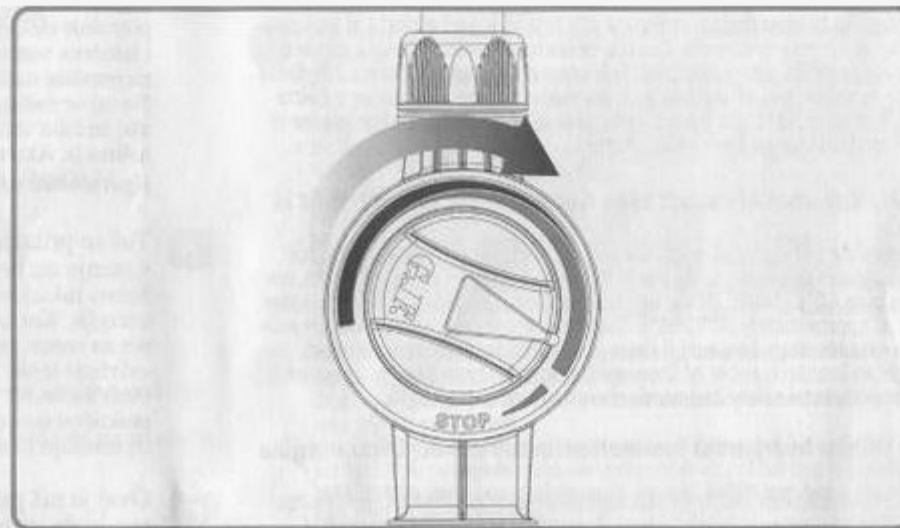

Note: Before use, switch the mixer to cold water. Then gradually turn the knob up to the desired temperature.

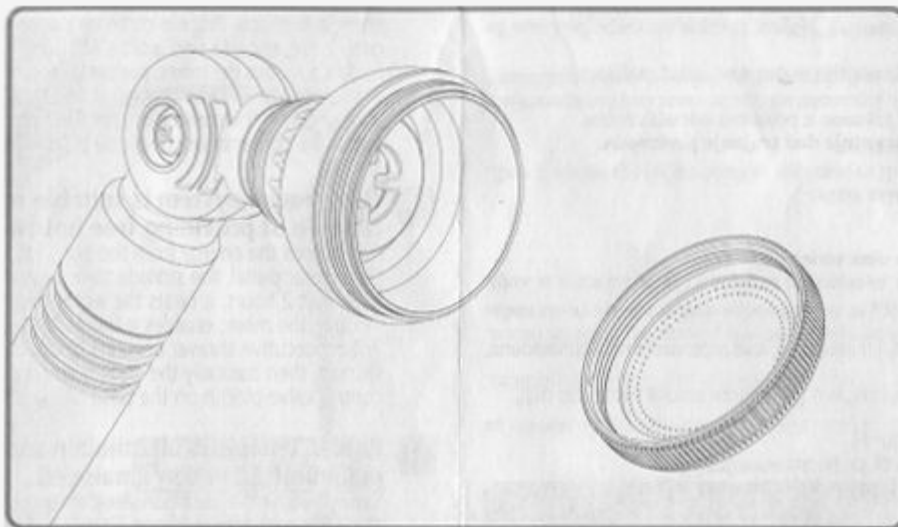

Note: After first usage and periodically, check that no impurities are in the drilled plate by opening the shower ring.

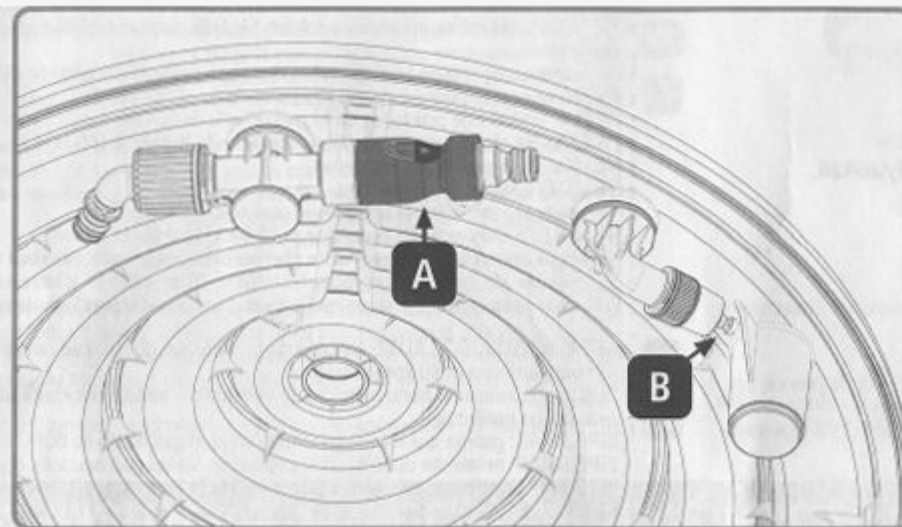

Note: Before assembling the set, check the presence of the pressure reduction valve (A) and safety valve (B).

## WARNING

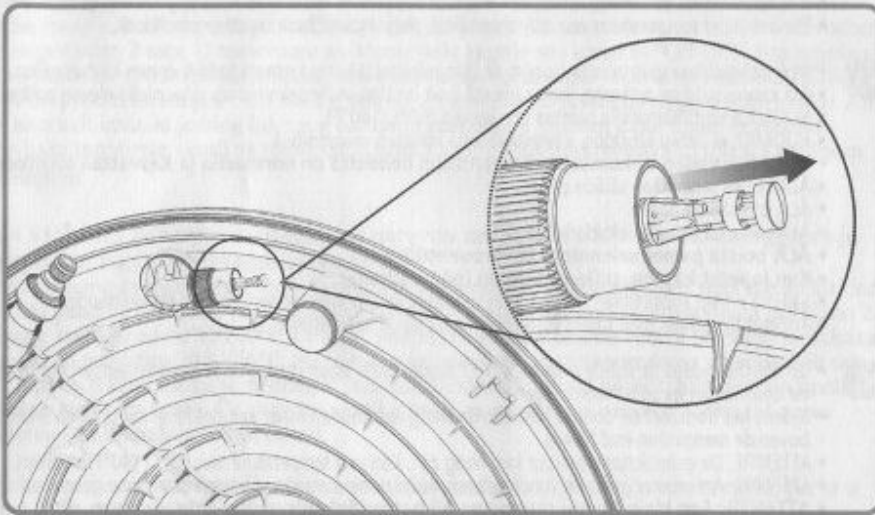

Periodically check that the safety valve is operating properly by gently pulling and releasing the knob in order to prevent scale sedimentation.

- DO NOT leave outside during cold months (keep safe from frost)
- During transport of shower do not hold the pipe, but lift the tank (possibly disassembling the top side of the pipe).
- ATTENTION: potential high working temperature. It can reach up 60°C/140°F.
- DO NOT let kids operate the shower.
- **WARNING: a light dripping just next to the safety valve has accepted, in order to assure a long lasting life of the article.**
- DO NOT step on the tank.
- DO NOT seat on the tank.
- DO NOT hang or sway by the shower pipe.
- **DO NOT remove the pressure reducing valve and safety valve.**
- **After use, always switch off the main power source (water inlet tap).**
- It is advised that you install a filter upstream of the tank in order to remove any impurities from the water.
- The indicated temperatures are only theoretical, they depend from weather conditions.

## OPTIONAL

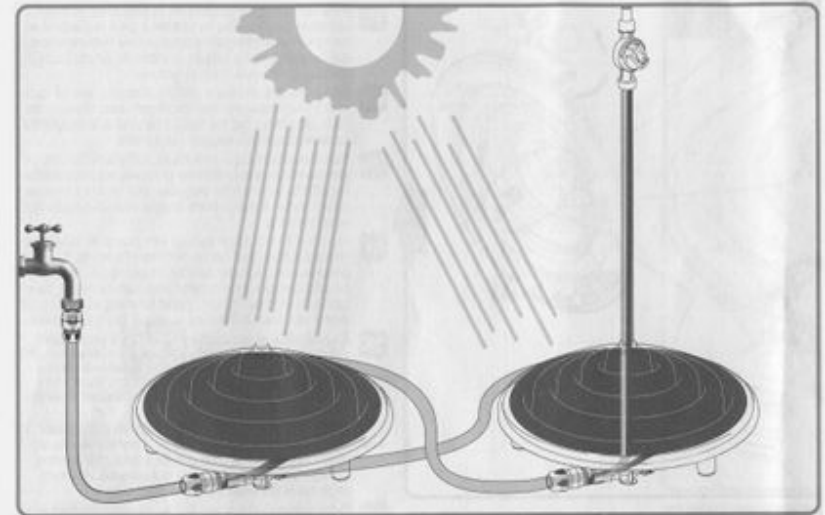

You can connect one or more tanks in series in order to increase the volume of available hot water.